

CITY OF WALDPORIT

Required Yard Setbacks

Residential Zones

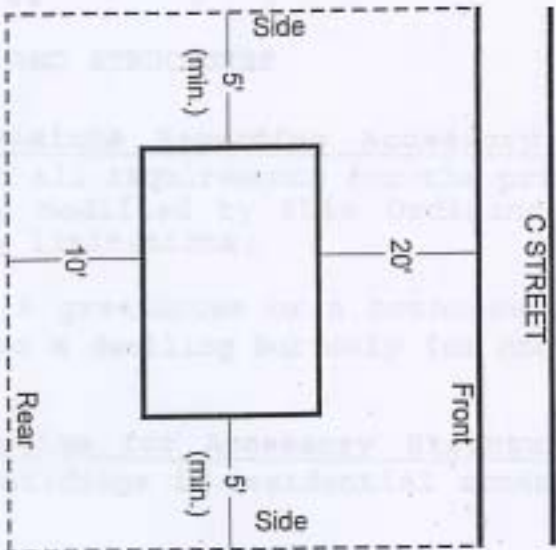

NON-CORNER LOT

MINIMUM SETBACKS:

FRONT - 20 FEET

REAR - 10 FEET

SIDES - 5 FEET or 1' FOR EACH 3' OF HEIGHT



Larry Lewis
City Planner
Fridays Only 8am-5pm
Waldport
P.O. Box 1120
Waldport, OR 97394
(541) 563-3561
(541) 563-5810 FAX
www.waldport.org

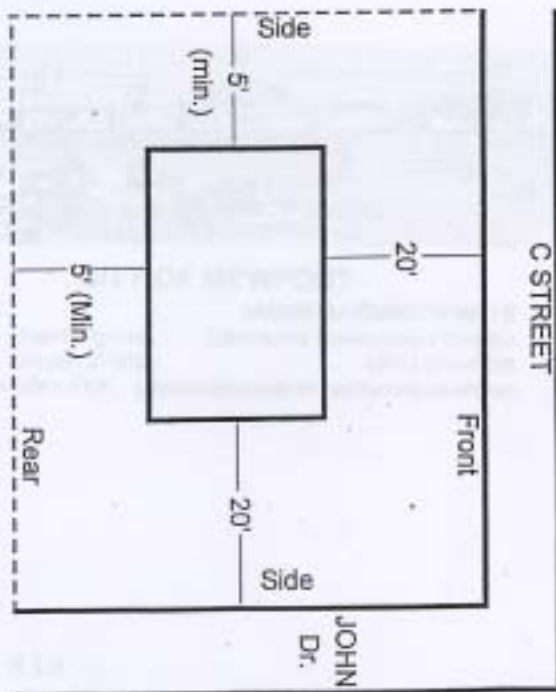

CORNER LOT

MINIMUM SETBACKS:

FRONT - 20 FEET

REAR - 5 FEET or 1' FOR EACH 3' OF HEIGHT

SIDE - 5 FEET or 1' FOR EACH 3' OF HEIGHT

STREET SIDE - 20 FEET; ON LOTS 50' WIDE OR LESS - 10'

NOTE: Yard requirements with "or" shall be the greater of the two measurements.

EXCEPTIONS

1. Setback on arterial streets - 60' from centerline
2. Setback on collector streets - 40' from centerline
3. In R-4 zone, front setback shall be 10' minimum
4. Front & rear yard size may be based on Sec. 5.030.1
5. Detached accessory structures may be able to comply with rear lot setbacks in Sec. 4.060.1